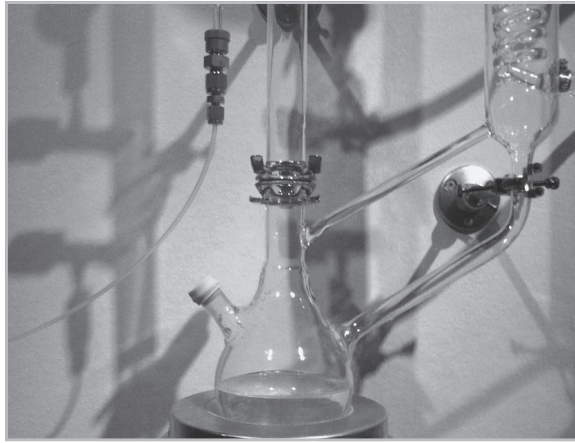

EXHIBIT GALLERIES



ORIGINS OF LIFE: Opens March 16 **NEW!**

Science and art intersect in a new exhibit, where glass tubing, gas bottles, bubbling liquids and zapping electricity form a working science experiment and a work of art that ask the question: Could life still be originating on Earth today? This visiting exhibition will remain at the Fleet through June 9, 2013.

GREAT BALLS OF FIRE: Comets, Meteors, Asteroids—must end Apr. 28

The threat of a catastrophic impact from an asteroid or comet is a staple of popular culture. If there was a dinosaur-killer in Earth's past, will humankind suffer the same fate? What are the chances and how do we assess the risks? For that matter, what *are* asteroids, comets, and meteorites, and where do they come from? Great Balls of Fire explores recent discoveries and cutting-edge science relating to these incredible objects. This exhibition coincides with the arrival of a new comet scheduled to make its appearance in the sky during March–April 2013.

EXPLOR-O-RAMA

Explore mechanics, motion, math, hearing, electricity, and many other areas of science in this “best of” exhibition from the popular Exploratorium in San Francisco. *Bilingual.*

BLOCK BUSTERS!

Build free-form structures—from skyscrapers to bridges—with thousands of wooden KEVA (Knowledge-Exploration-Visual Arts) planks. Be inspired by 50 amazing models built by our block engineers.

TINKERING STUDIO

Channel Thomas Edison, Rube Goldberg, or Steve Jobs as the “Tinkering Studio” returns by popular demand! This hands-on work area inspires experimentation and collaboration amongst the whole family. Come on in to create, invent, and explore.

The Tinkering Studio was made possible by a major gift in honor of Grace and Jeffrey, and generous grants from the Kenneth T. and Eileen L. Norris Foundation and the Mandell Weiss Charitable Trust.

AGING FOR ALL AGES

This exhibition teaches about wellness and healthy lifestyle choices through fun and engaging interactive exhibits.

Produced by the Reuben H. Fleet Science Center and funded by a grant from the MetLife Foundation Partnership for Lifelong Learning. Additional support provided by Aging & Independence Services, a division of the County of San Diego's Health and Human Services Agency.

NANO

NANO—Imagine and Discover a World You Can't See! is a new, engaging exhibition about nanoscale science, technology and engineering. Join us as we explore a small world where big science happens. This 400-square-foot exhibition includes hands-on interactives that invite you to dive into the nano world and discover its real-world applications and implications. *Bilingual.*

“NANO” was created by the Nanoscale Informal Science Education Network (NISE Network) with support from the National Science Foundation.

KID CITY

Kids age five and under get to explore our working world in a safe learning environment. The colorful, hands-on cityscape includes a Grocery Store, Fire Station, Factory, Power Plant, and Little Learners Lab, plus an Infants Only Area. *Bilingual.*

The “Kid City” exhibition is made possible by generous gifts and grants from the Donald C. and Elizabeth M. Dickinson Foundation, the Nierman Family Fund at the San Diego Jewish Community Foundation, an Anonymous Donor, the Mandell Weiss Charitable Trust, and a sponsorship from ScholarShare College Savings Plan.

CELLULAR JOURNEY

Check out the exhibition that introduces you to human cell biology, the importance of stem cells, and the potential impact of stem cells on medical research in the fields of regenerative and personalized medicine.

Made possible by a grant from the Life Technologies Foundation, a non-profit arm of Life Technologies Corporation based in Carlsbad, CA.

GALLERY MAP & HOURS

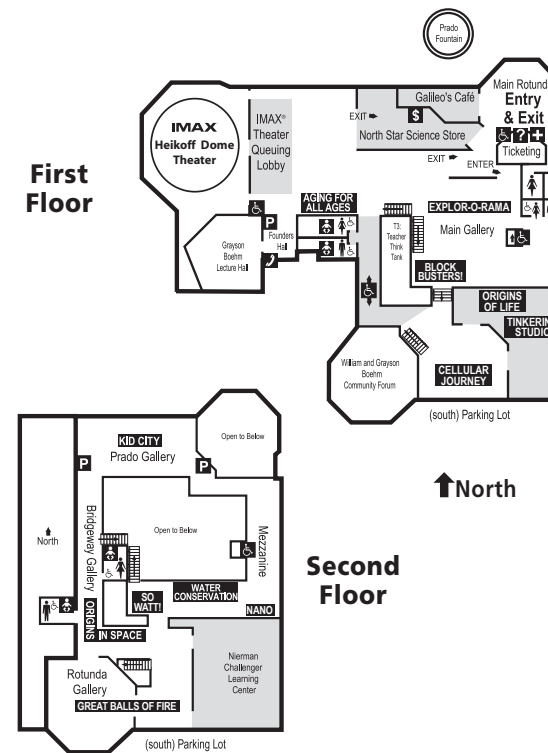

MARCH HOURS

MON-THU	10:00 AM–5:00 PM
FRI-SAT	10:00 AM–7:00 PM
SUN	10:00 AM–6:00 PM

Extended hours! Open until 8 p.m. on Friday nights, March 15, 22 and 29. Hours subject to change. Please check our website when planning your visit.

Financial support for the Reuben H. Fleet Science Center is provided in part by the City of San Diego Commission for Arts and Culture.



The ‘LEED Certification Mark’ is a registered trademark owned by the U.S. Green Building Council and is used by permission.

30% TOTAL FROM RECOVERED FIBER

MARCH 2013 SCHEDULE



Enjoy our year-long salute!

IMAX® Films & Planetarium Show Schedule Inside



OPENS MARCH 9



And more! Look inside.

**1875 El Prado • San Diego
www.rhfleet.org • 619.238.1233**

IMAX® is a registered trademark of IMAX CORPORATION.